

# RFWB-40G/MT | On-wall button controllers 4 buttons MATTER

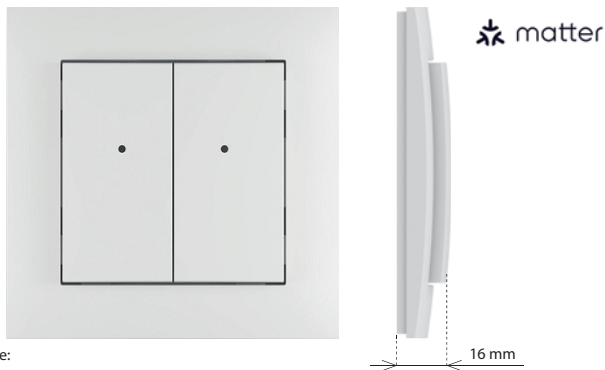

EAN code:  
RFWB-40G/MT: 8595188189545

Technical parameters		RFWB-40G/MT
Supply voltage:	3 V CR 2032 battery	
Battery life:	around 2 years based on frequency of use	
Transmission indication:	red LED	
Number of buttons:	4	
Application protocol:	Matter	
Communication protocol:	THREAD	
Frequency:	2,4 GHz	
Maximum EIRP:	< 14 dBm	
Signal transmission method:	MESH	
Range:	in open space up to 200 m	
Other data		
Operating temperature:	-10 to +50 °C	
Operating position:	any	
Mounting:	glue/screws	
Protection:	IP20	
Contamination degree:	2	
Dimensions frame		
- plastic:	85 x 85 x 16 mm	
- metal, glass, wood, granite:	94 x 94 x 16 mm	
Weight (plastic):	39 g	
Related standards:	EN 60730, EN 63044, EN 301489-1, 301489-17, EN 300328	

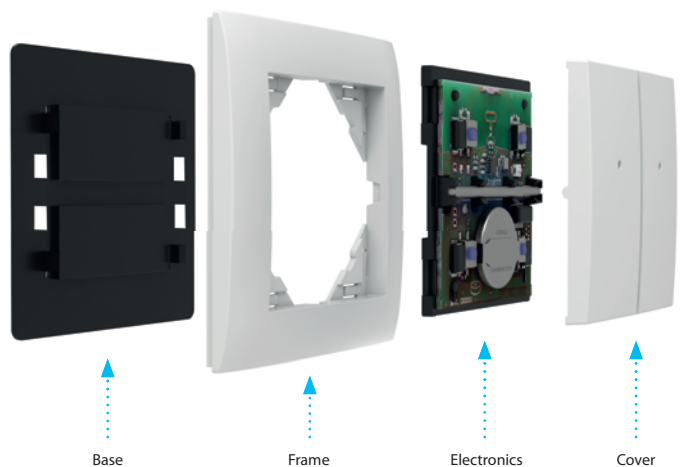

- The pushbutton type wall-mounted controllers are used to control switches and dimmers (of lights, barriers, gates, window shutters, etc.).
- It communicates on the Thread protocol that guarantees compatibility with other products with the Matter support.
- Its flat design with a flat base predestines it for quick installation on any surface (by sticking or screwing it onto a junction box).
- After a short pressing the pushbutton, it transmits the preset command (short pressing, long pressing).
- Transmission of the command is indicated by a red LED.
- Design of the LOGUS90 switch frames (plastics, glass, wood, metal, stone).
- Battery power supply (3V battery CR 2032 is included) with lifetime of approx. 2 years, depending on the frequency of use.
- The applicable reach is up to 200m (in free area).
- The element with the actuator can be paired through a border router supporting Matter and through an application supporting Matter. The border router is understood as equipment such as HomePod Mini, Google Nest Hub or Samsung SmartThings Station.

## Device description

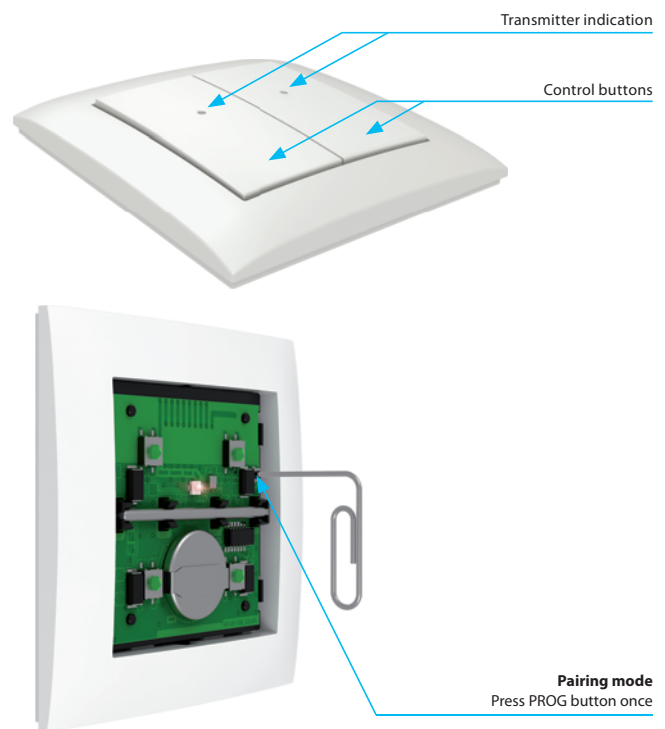

## Device pairing

Before pairing a Matter device using a Matter QR code or numerical code, the device must be put into pairing mode.

To enter **pairing mode**, press the PROG button once.

To pair an already configured device, it needs to be reset to **factory settings**. This is done by pressing and holding the PROG button for more than 10 seconds.

Entering the pairing mode is signaled by short flashes of the red LED.

## LOGUS<sup>90</sup>

### Choose your own style

Flat wireless switches that can be mounted on glass, tile, furniture ... Such a quick change of location when you're moving.

